



**FOR LEASE**

# Launch Coworking Space

**185 CARLTON STREET, WINNIPEG, MB**

PRESLEY BORDIAN, Senior Advisor, Sales & Leasing

(204) 985-1356

[presley.bordian@capitalgrp.ca](mailto:presley.bordian@capitalgrp.ca)

**Capital**

COMMERCIAL REAL ESTATE  
SERVICES INC.

[capitalgrp.ca](http://capitalgrp.ca)

# Property Details

## AVAILABILITY

- Single occupant private offices
- Large executive private offices
- Team suites to accommodate multiple occupants

## RENTAL RATE

\$599.00 per month - \$4,799.00 per month

\*Contact agent for more detail

## ADDITIONAL OPTIONS

- Add mailing & shipping addresses at \$29.00 per month
- Add virtual office address at \$49.00 per month (Google my business address)
- Add interior design & furniture package
- Add monitor at \$29.00 per month per person
- Add coffee & tea service at \$19.00 per month per person
- Add locker at \$19.00 per month
- Add team sharing up to 6 people at \$29.00 per month

## HIGHLIGHTS

- **Brand new, state-of-the-art** office space with upgraded building features
- **On-site cafe** operating 7am-3pm; member discounts available
- Directory board **signage available** for executive suite members or team suite members
- Individualized IT can be accommodated
- Office branding available
- Access to **on-site amenities** such as event spaces, boardrooms, meeting spaces, private call rooms, collaborating space, and more
- Membership fee's **payable monthly, quarterly, or bi-annually**
- Offices equipped with **electric standing desk and ergonomic office chair**





# Interior Photos



# Floor Plan

## EXECUTIVE UNITS

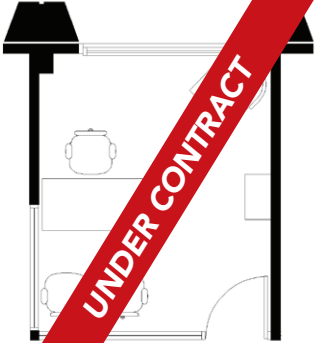

EXEC 232

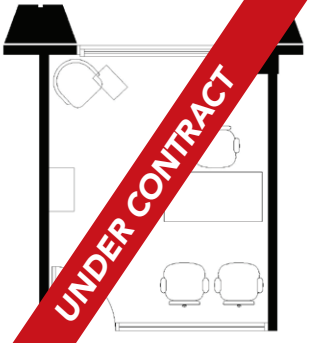

EXEC 234

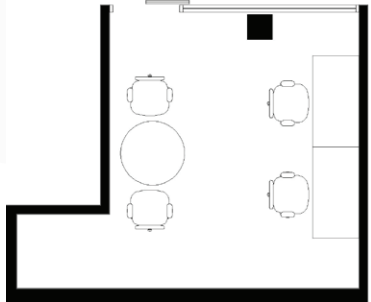

EXEC 303

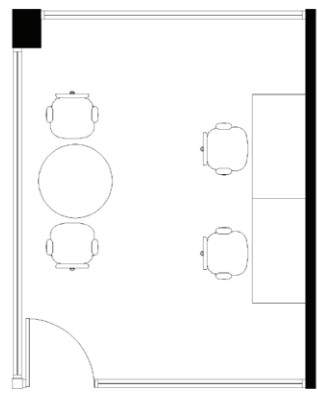

EXEC 314

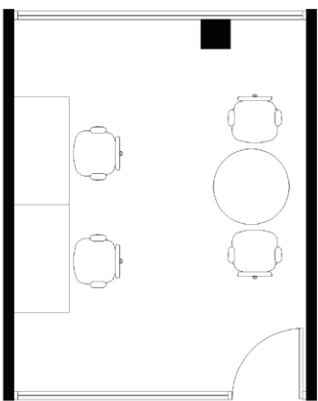

EXEC 315

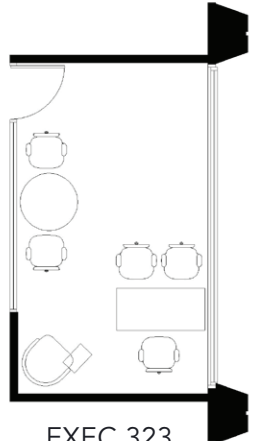

EXEC 323

# Floor Plan

## INDIVIDUAL UNITS

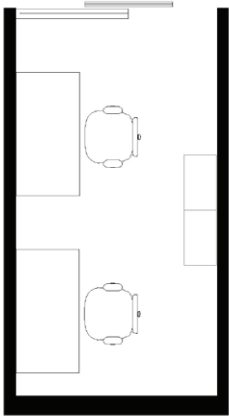

INDIV 210

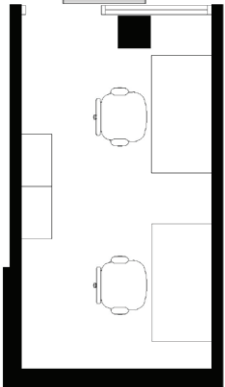

INDIV 211

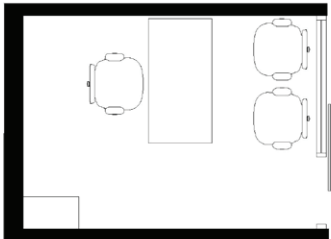

INDIV 214

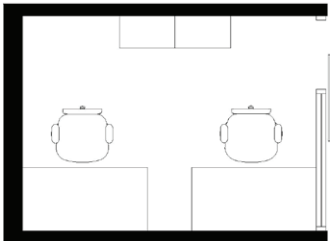

INDIV 215

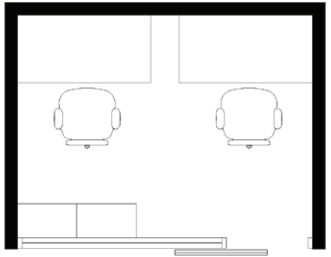

INDIV 219

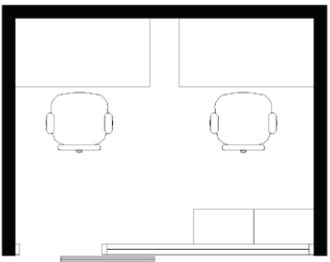

INDIV 220

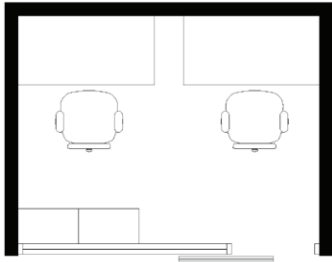

INDIV 221

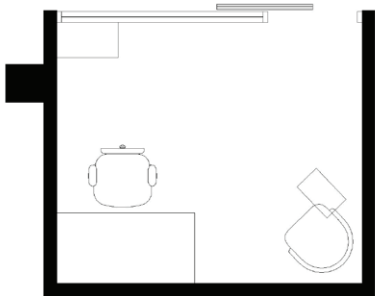

INDIV 223

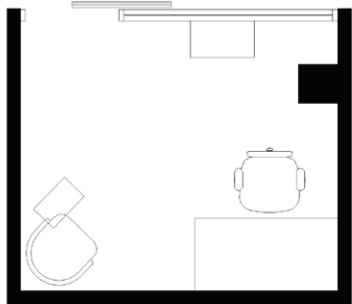

INDIV 224

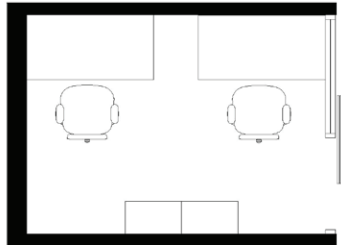

INDIV 228

# Floor Plan

## INDIVIDUAL UNITS

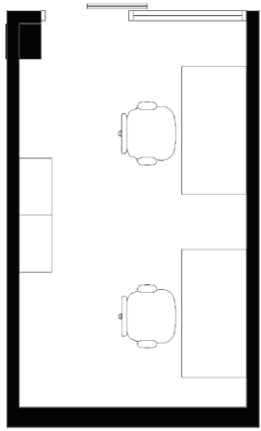

INDIV 308

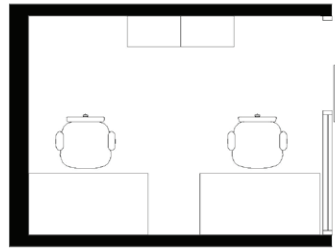

INDIV 310

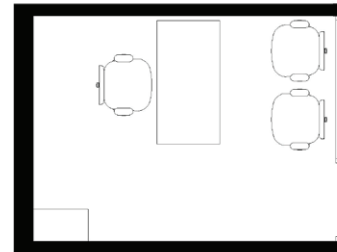

INDIV 311

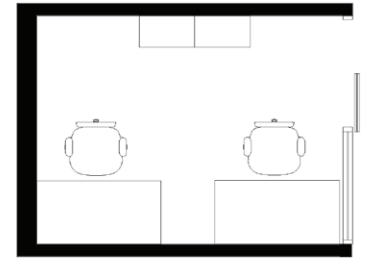

INDIV 312

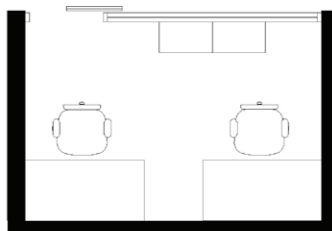

INDIV 318

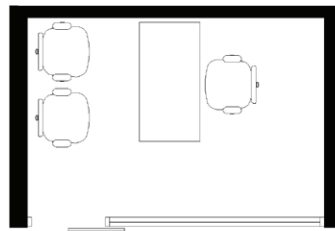

INDIV 319

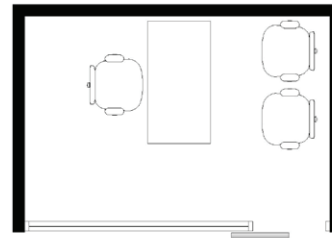

INDIV 320

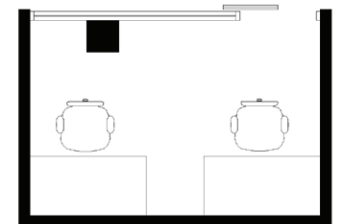

INDIV 321

# *Floor Plan*

## MICRO UNITS

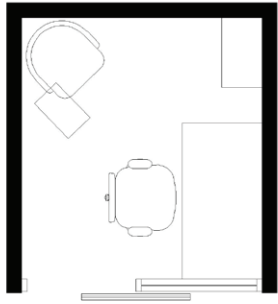

MICRO 218

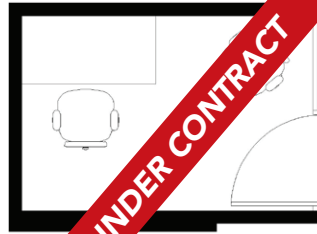

MICRO 301

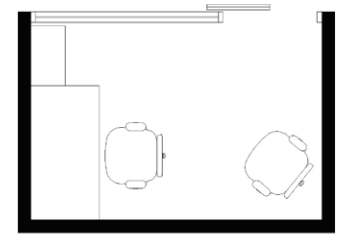

MICRO 302

# *Floor Plan*

## TEAM SUITES

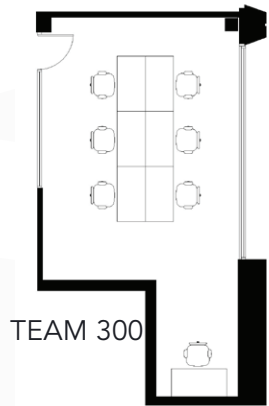

TEAM 300

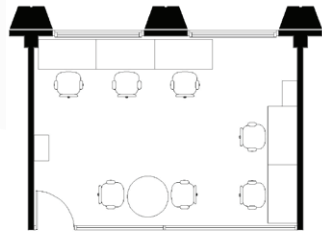

TEAM 325

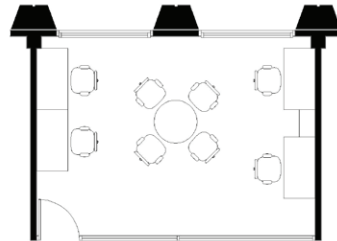

TEAM 326

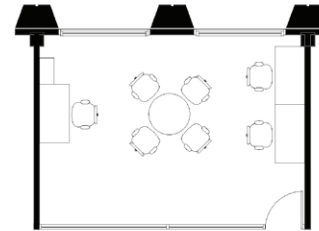

TEAM 327

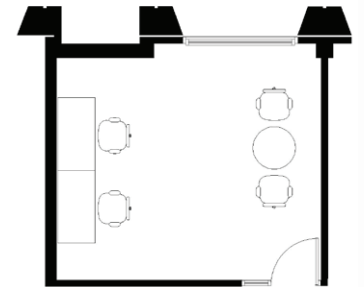

TEAM 328





185  
Carlton

## *Premuim Location*

- Strategically located in the heart of Downtown Winnipeg's SHED
- Direct connection to the downtown's climate-controlled skywalk and concourse systems
- Indoor connection to key area highlights including RBC Convention Centre, Delta Winnipeg, True North Square and City Place
- Located close to most of the development activity in downtown Winnipeg
- Generous underground and surface parking in the immediate area
- Located on major traffic arteries
- Well-served by Winnipeg Transit



# The SHED District

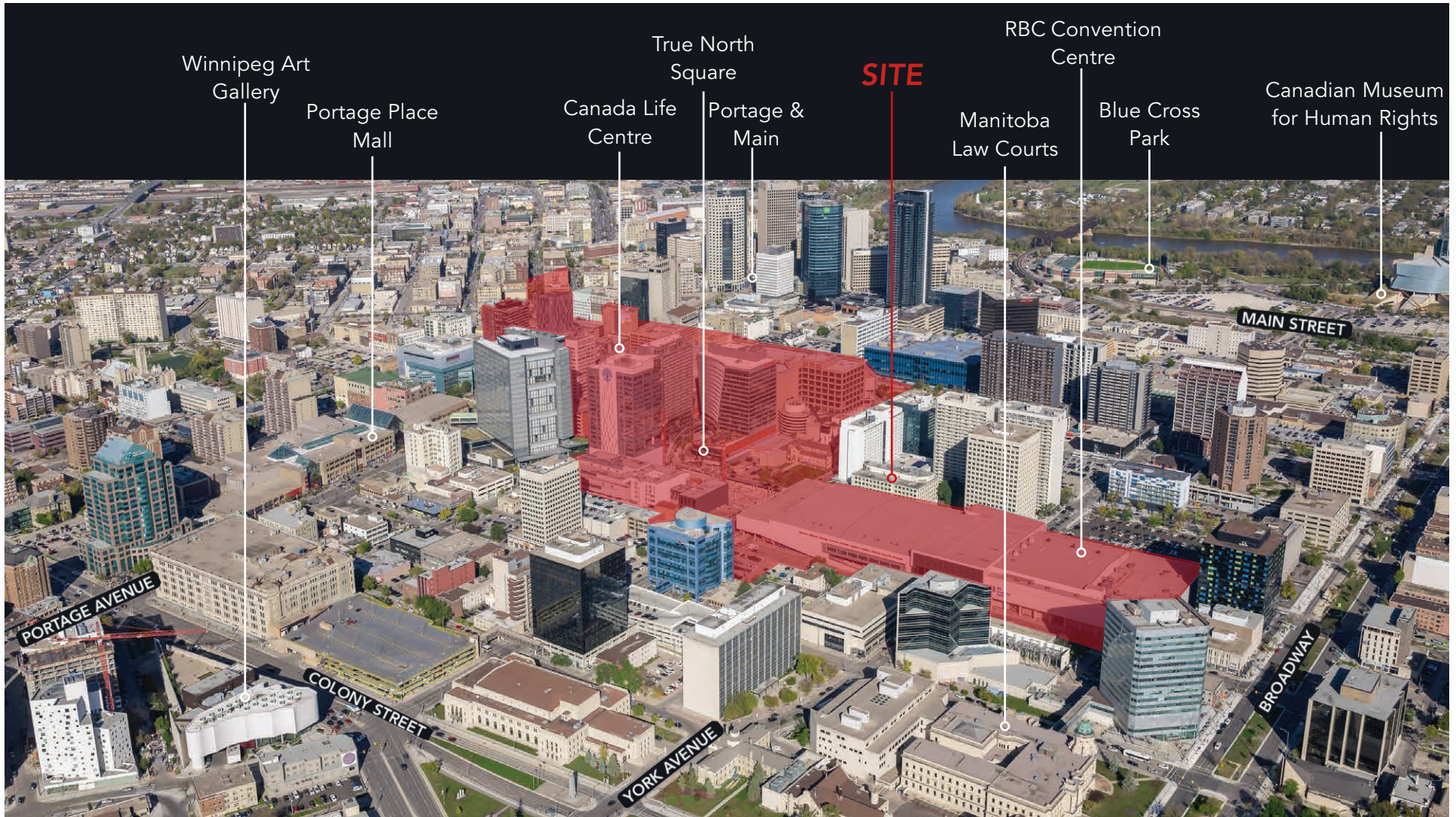

**11** city blocks



**4** hotels including the new Alt Hotel and the 288-room Sutton Place Hotel now under construction



**20+** restaurants including Merchant Kitchen Gusto North and Rudy's



**6** entertainment & sports venues including the Royal Winnipeg Ballet, Canada Life Centre, and the MET





COMMERCIAL REAL ESTATE  
SERVICES INC.

## Contact

PRESLEY BORDIAN, Senior Advisor, Sales & Leasing

(204) 985-1356

[presley.bordian@capitalgrp.ca](mailto:presley.bordian@capitalgrp.ca)

**CAPITAL COMMERCIAL REAL ESTATE SERVICES INC.**

300-570 Portage Avenue, Winnipeg, MB R3C 0G4 | T (204) 943-5700 | F (204) 956-2783 | [capitalgrp.ca](http://capitalgrp.ca)

Disclaimer: Capital Commercial Real Estate Services Inc. ("Capital") does not accept or assume any responsibility or liability, direct or consequential, for the information set out herein, including, without limitation, any projections, images, opinions, assumptions and estimates obtained from third parties. This information has not been verified by Capital, and Capital does not guarantee the accuracy, correctness and completeness of this information. The recipient of this information should take such steps as the recipient may deem necessary to verify the information in this document prior to placing any reliance upon it. The information may change and any property described in this document may be withdrawn from the market at any time without notice or obligation to the recipient from Capital.