

~ *New Industrial Building Available in Portage la Prairie* ~



**FOR SALE**

# 93 Poplar Bluff

**PORTAGE LA PRAIRIE, MB**

DAWSON GROENING, Advisor, Sales & Leasing  
(204) 985-1383  
[dawson.groening@capitalgrp.ca](mailto:dawson.groening@capitalgrp.ca)

ERIC OTT, Associate Vice President, Sales & Leasing  
(204) 985-1378  
[eric.ott@capitalgrp.ca](mailto:eric.ott@capitalgrp.ca)  
Services provided by Eric A. Ott Personal Real Estate Corporation

  
**Capital**  
COMMERCIAL REAL ESTATE  
SERVICES INC.

[capitalgrp.ca](http://capitalgrp.ca)

# Property Details

**BUILDING AREA (+/-)** 5,400 sq. ft.

---

**LAND AREA (+/-)** 5.12 acres

---

**SALE PRICE** \$1,200,000.00

---

**PROPERTY TAXES** \$3,880.06

---

**LOADING** (4) 16ft. overhead doors

---

**ZONING** MP - Industrial Poplar Bluff Zone

---

**CLEAR HEIGHT (+/-)** 18 ft.

---

**ELECTRICAL** 400 Amp, 220 Volt, Single Phase service

---

**AVAILABILITY** Immediately

---

## **HIGHLIGHTS**

- Located minutes from Portage la Prairie, just off the TransCanada Highway, and immediately adjacent to Simplot, Roquette, Enns Brothers, Catapult Environmental and more



# Floor Plan

## MAIN FLOOR

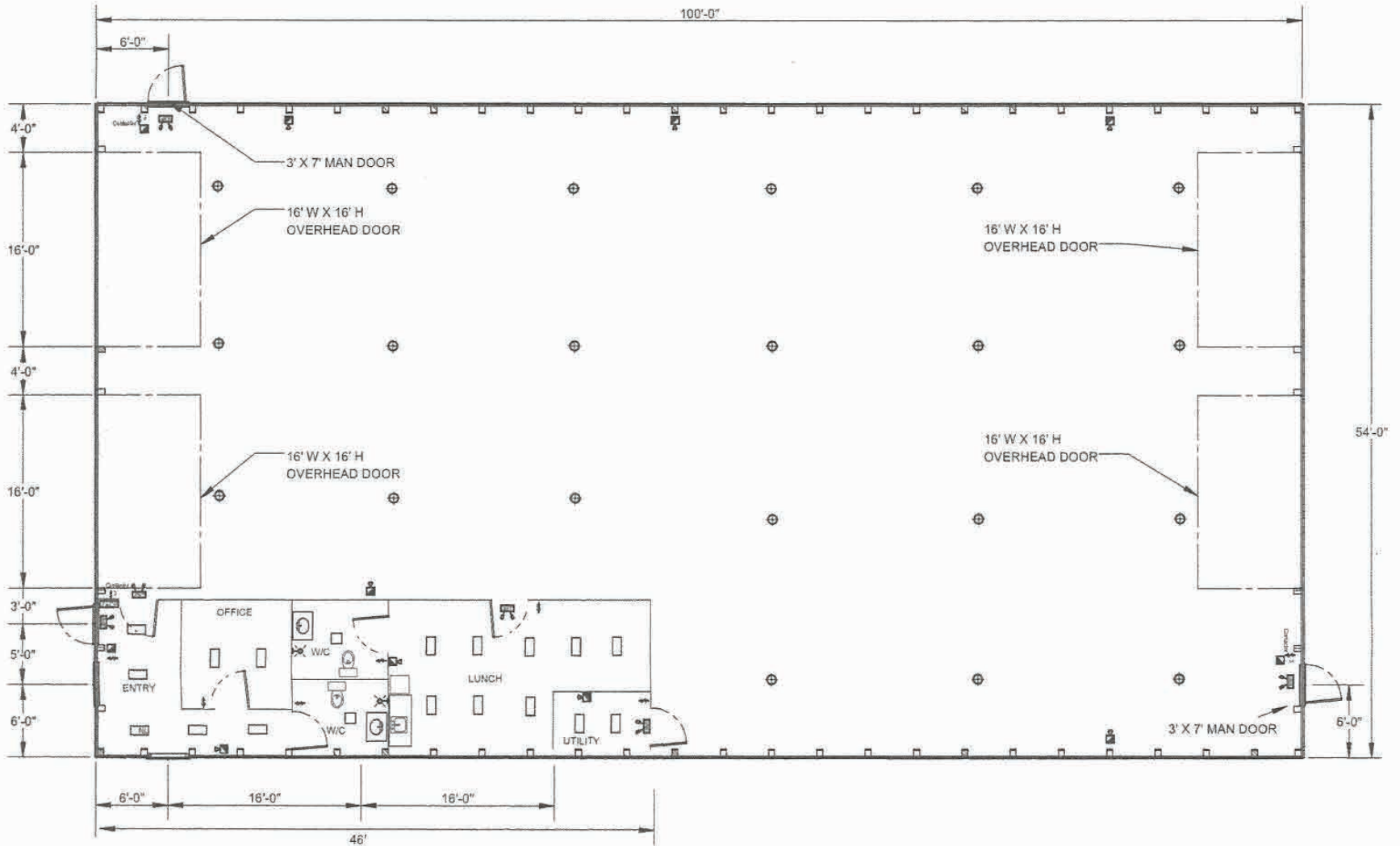

# Floor Plan

## SECOND PLAN

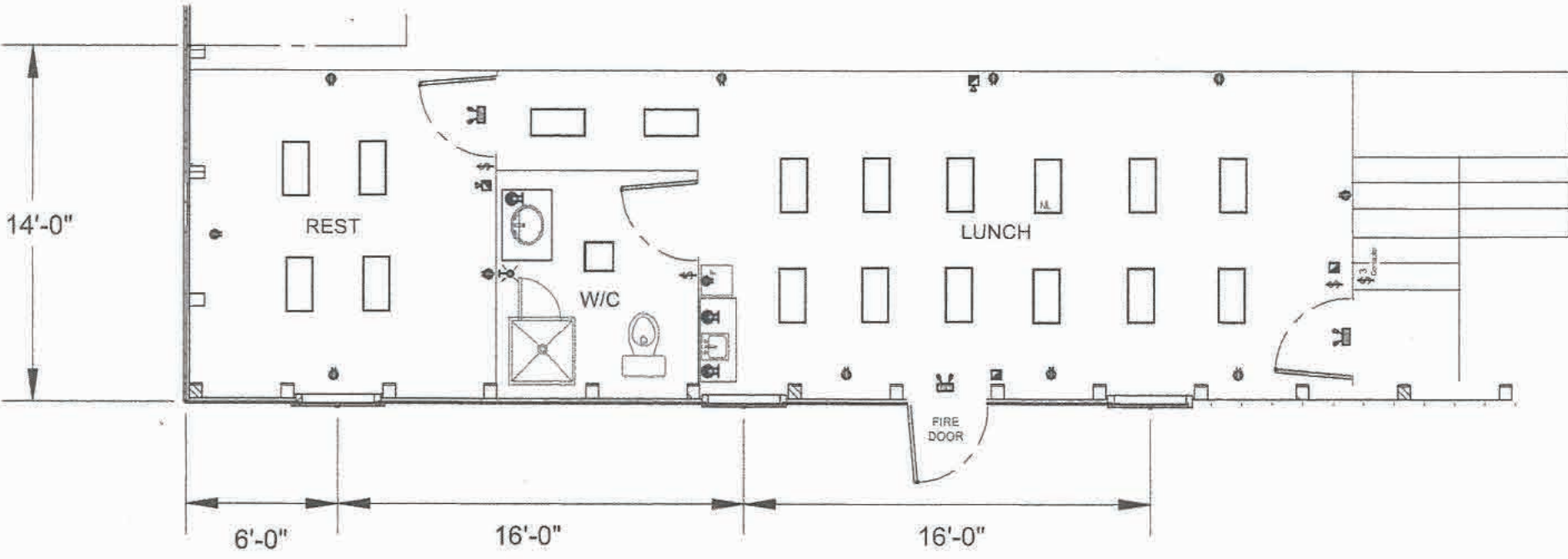

# Lot Plan



# Area Overview



# Location Map

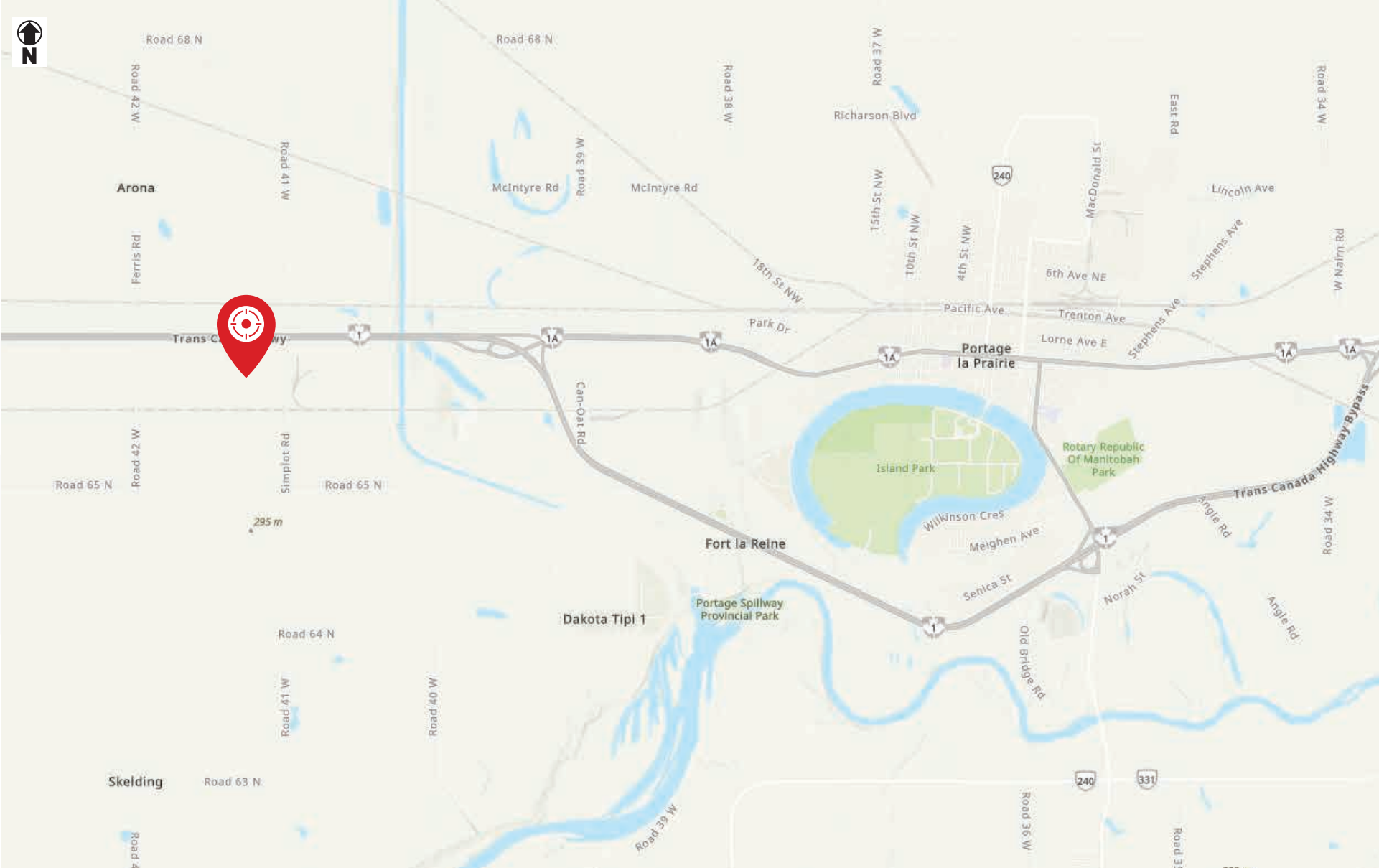



COMMERCIAL REAL ESTATE  
SERVICES INC.

# Contact

DAWSON GROENING, Advisor, Sales & Leasing  
(204) 985-1383  
[dawson.groening@capitalgrp.ca](mailto:dawson.groening@capitalgrp.ca)

ERIC OTT, Associate Vice President, Sales & Leasing  
(204) 985-1378  
[eric.ott@capitalgrp.ca](mailto:eric.ott@capitalgrp.ca)

*Services provided by Eric A. Ott Personal Real Estate Corporation*

**CAPITAL COMMERCIAL REAL ESTATE SERVICES INC.**

300-570 Portage Avenue, Winnipeg, MB R3C 0G4 | T (204) 943-5700 | F (204) 956-2783 | [capitalgrp.ca](http://capitalgrp.ca)

Disclaimer: Capital Commercial Real Estate Services Inc. ("Capital") does not accept or assume any responsibility or liability, direct or consequential, for the information set out herein, including, without limitation, any projections, images, opinions, assumptions and estimates obtained from third parties. This information has not been verified by Capital, and Capital does not guarantee the accuracy, correctness and completeness of this information. The recipient of this information should take such steps as the recipient may deem necessary to verify the information in this document prior to placing any reliance upon it. The information may change and any property described in this document may be withdrawn from the market at any time without notice or obligation to the recipient from Capital.