

~ Industrial Warehouse in South Landing Business Park ~



**FOR LEASE**

# 25 South Landing Drive

**RM OF MACDONALD, MB**

Eric Ott, Associate Vice President, Sales & Leasing  
(204) 985-1378

[eric.ott@capitalgrp.ca](mailto:eric.ott@capitalgrp.ca)

*Services provided by Eric A. Ott Personal Real Estate Corporation*

Gary Goodman, Vice President, Sales & Leasing  
(204) 997-4831

[gary.goodman@capitalgrp.ca](mailto:gary.goodman@capitalgrp.ca)



[capitalgrp.ca](http://capitalgrp.ca)

# Property Overview

## PROPERTY DETAILS

<b>BUILDING AREA (+/-)</b>	15,041 sq. ft.
<b>AREA AVAILABLE (+/-)</b>	4,863 sq. ft.
<b>NET RENTAL RATE</b>	\$16.95 per sq. ft.
<b>ADDITIONAL RENT</b>	\$5.85 per sq. ft.
<b>LOADING</b>	One 10' x 9' Dock door with leveler One 16' x 14' Grade door
<b>ZONING</b>	ML - Light Industrial
<b>CEILING HEIGHT (+/-)</b>	24 ft.
<b>ELECTRICAL</b>	250 Amp, 347/600 Volt, 3 Phase
<b>AVAILABILITY</b>	Immediately

### HIGHLIGHTS

- No City of Winnipeg Business Tax
- Fenced secure yard
- Excellent visibility and access from McGillivray Boulevard
- Close proximity to the amenities of Kenaston Boulevard and McGillivray Boulevard
- Paved roadways to allow for heavy truck traffic

## FLOOR PLAN

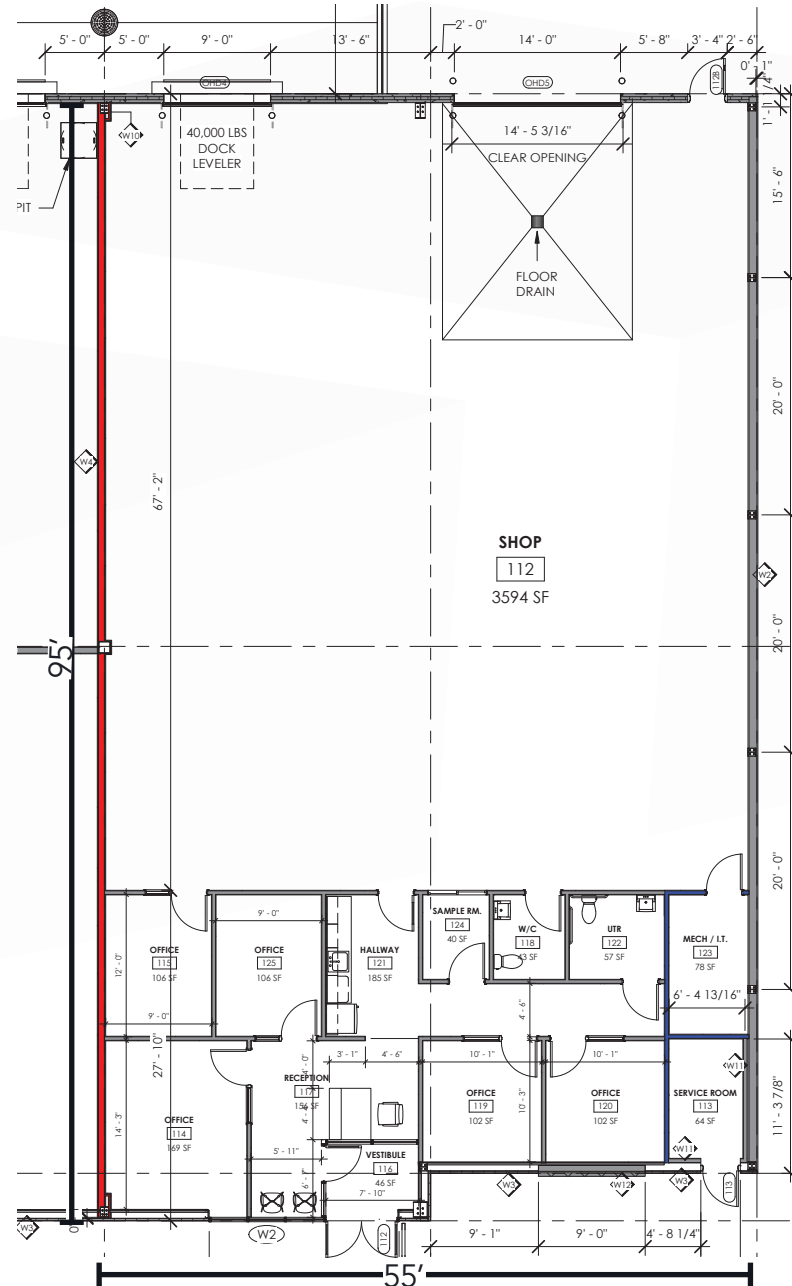

# Site Plan

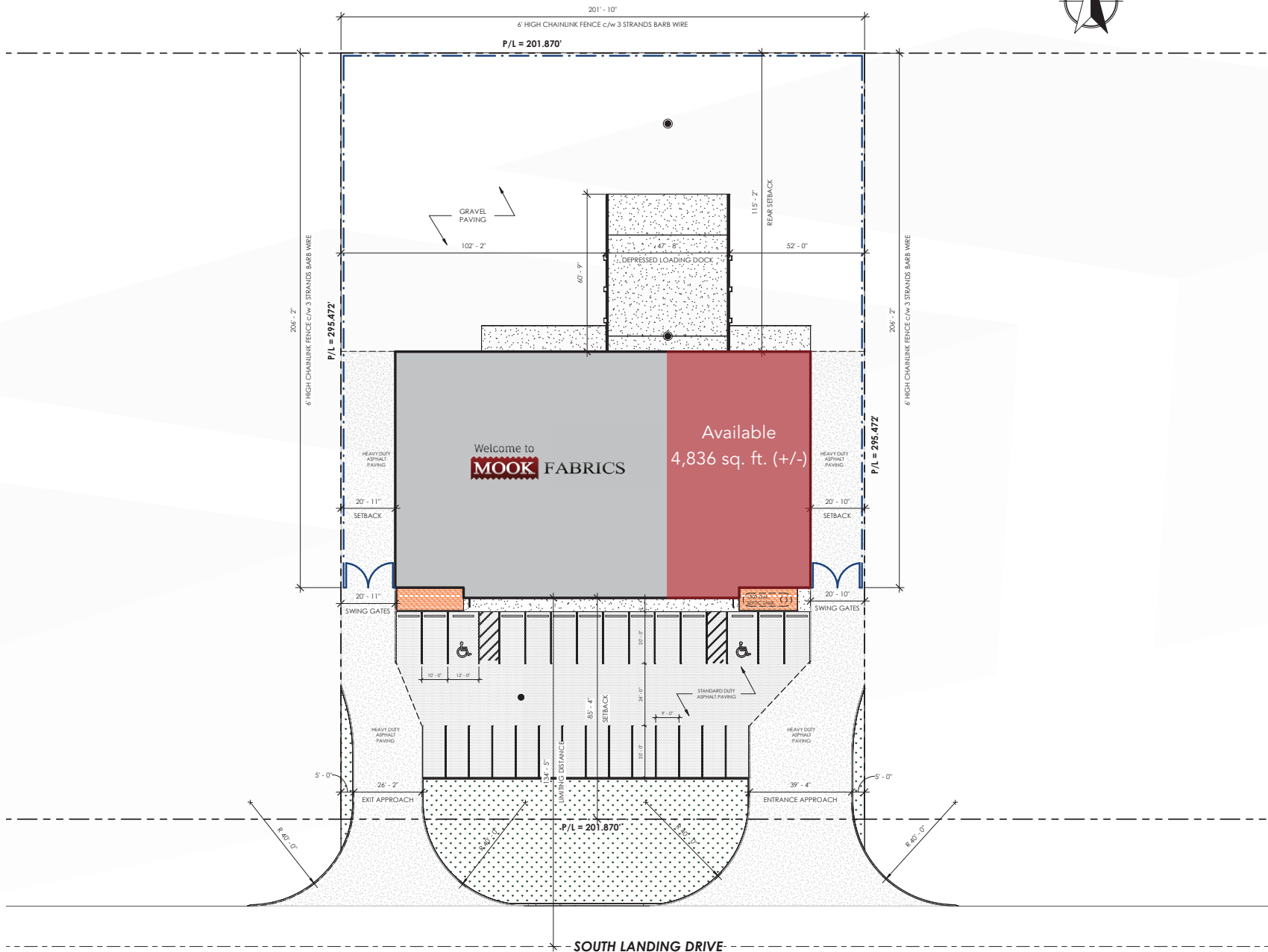

# Photos



# Southwest Winnipeg Overview Aerial



# Location Aerial



# Location Overview





COMMERCIAL REAL ESTATE  
SERVICES INC.

# Contact

Eric Ott, Associate Vice President, Sales & Leasing

(204) 985-1378

[eric.ott@capitalgrp.ca](mailto:eric.ott@capitalgrp.ca)

Services provided by Eric A. Ott Personal Real Estate Corporation

Gary Goodman, Vice President, Sales & Leasing

(204) 997-4831

[gary.goodman@capitalgrp.ca](mailto:gary.goodman@capitalgrp.ca)

**CAPITAL COMMERCIAL REAL ESTATE SERVICES INC.**

300-570 Portage Avenue, Winnipeg, MB R3C 0G4 | T (204) 943-5700 | F (204) 956-2783 | [capitalgrp.ca](http://capitalgrp.ca)

Disclaimer: Capital Commercial Real Estate Services Inc. ("Capital") does not accept or assume any responsibility or liability, direct or consequential, for the information set out herein, including, without limitation, any projections, images, opinions, assumptions and estimates obtained from third parties. This information has not been verified by Capital, and Capital does not guarantee the accuracy, correctness and completeness of this information. The recipient of this information should take such steps as the recipient may deem necessary to verify the information in this document prior to placing any reliance upon it. The information may change and any property described in this document may be withdrawn from the market at any time without notice or obligation to the recipient from Capital.