

~ Industrial space in the immediate vicinity of the airport ~



**FOR LEASE**

# 47-73 Airport Road WINNIPEG, MB

Gary Goodman, Vice President, Sales & Leasing  
(204) 997-4831  
[gary.goodman@capitalgrp.ca](mailto:gary.goodman@capitalgrp.ca)

Eric Ott, Associate Vice President, Sales & Leasing  
(204) 985-1378  
[eric.ott@capitalgrp.ca](mailto:eric.ott@capitalgrp.ca)  
*Services provided by Eric A. Ott Personal Real Estate Corporation*

  
**Capital**  
COMMERCIAL REAL ESTATE  
SERVICES INC.

[capitalgrp.ca](http://capitalgrp.ca)

# Property Overview

## PROPERTY DETAILS

BUILDING AREA (+/-)	35,000 sq. ft.
AREA AVAILABLE (+/-)	Unit 71-73: 5,000 sq. ft.
NET RENTAL RATE	\$9.50 per sq. ft.
ADDITIONAL RENT	\$5.23 per sq. ft.
LOADING	2 Dock Level Doors
ZONING	M2 Industrial
AVAILABILITY	Immediately

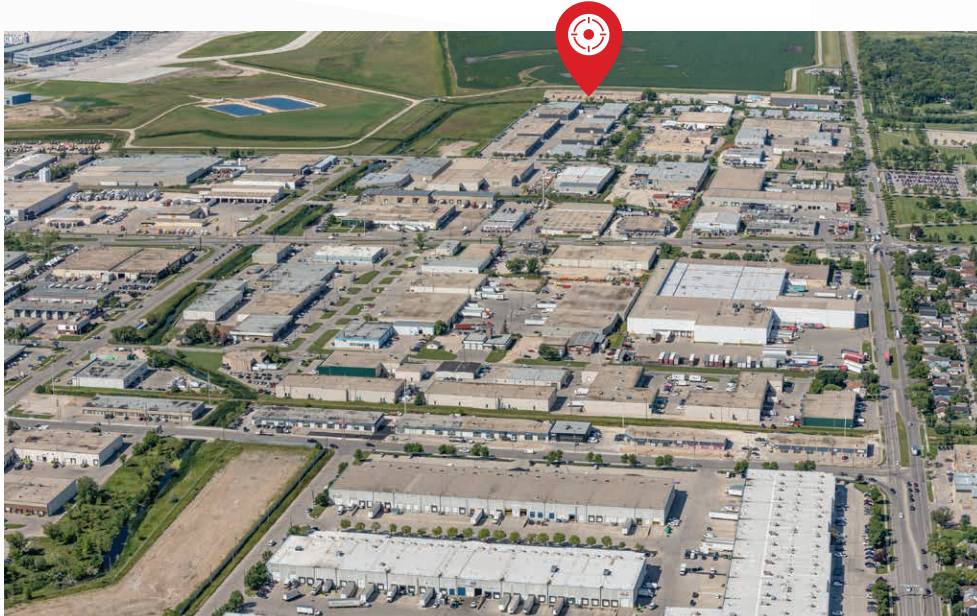

## Property Highlights

- Industrial space in close proximity to the James Armstrong Richardson International Airport and all of the retail amenities of the Polo Park Retail Node
- Easy access to major transit routes
- On-site parking
- Developed office space



# Site Plan

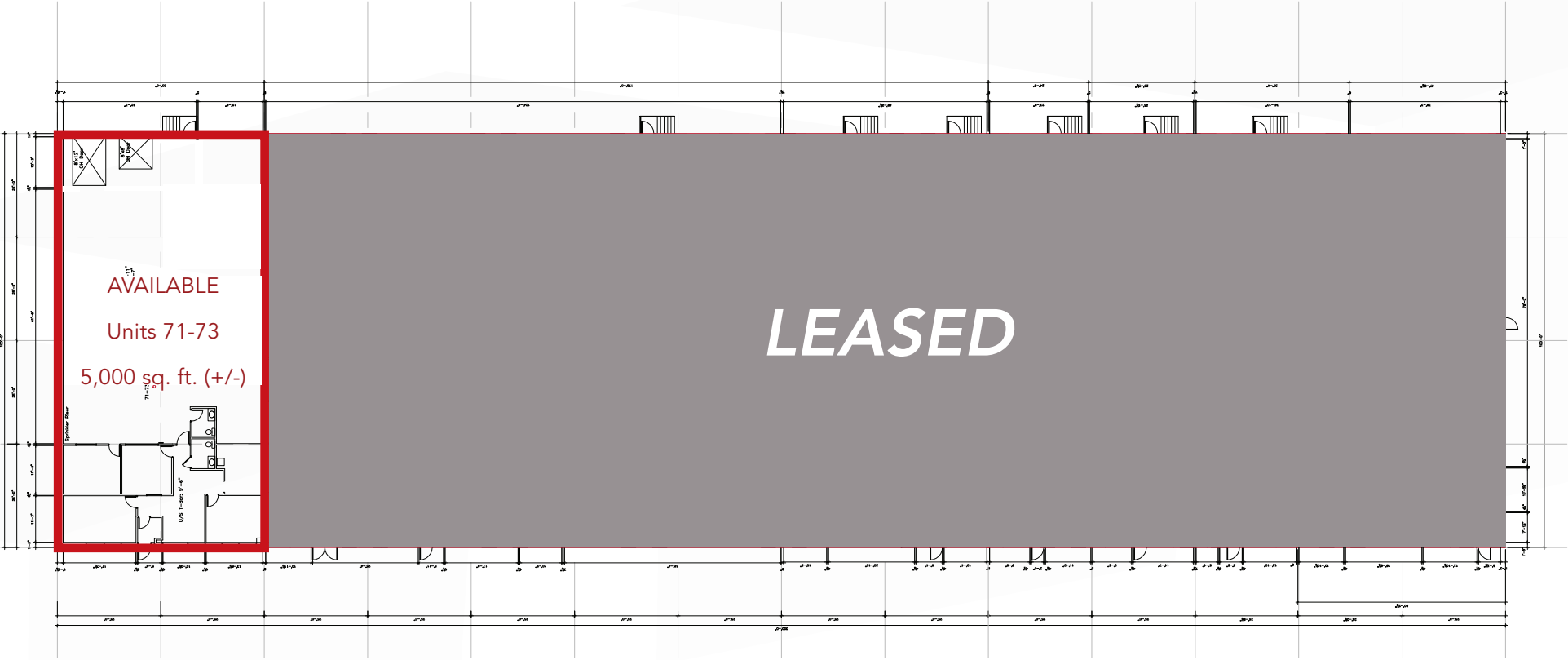

# Floor Plan

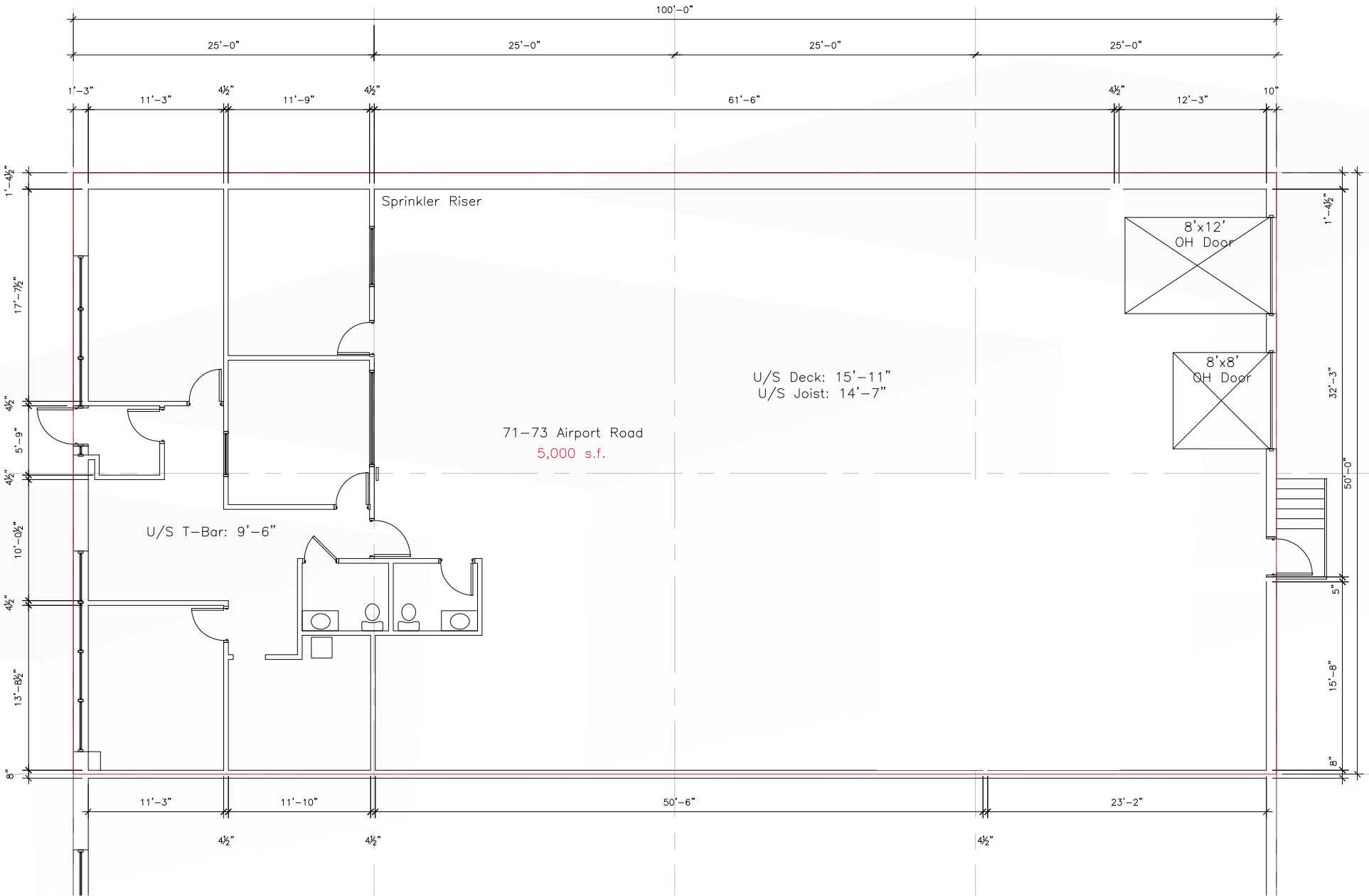

# Site Aerial



# Drive Time Map

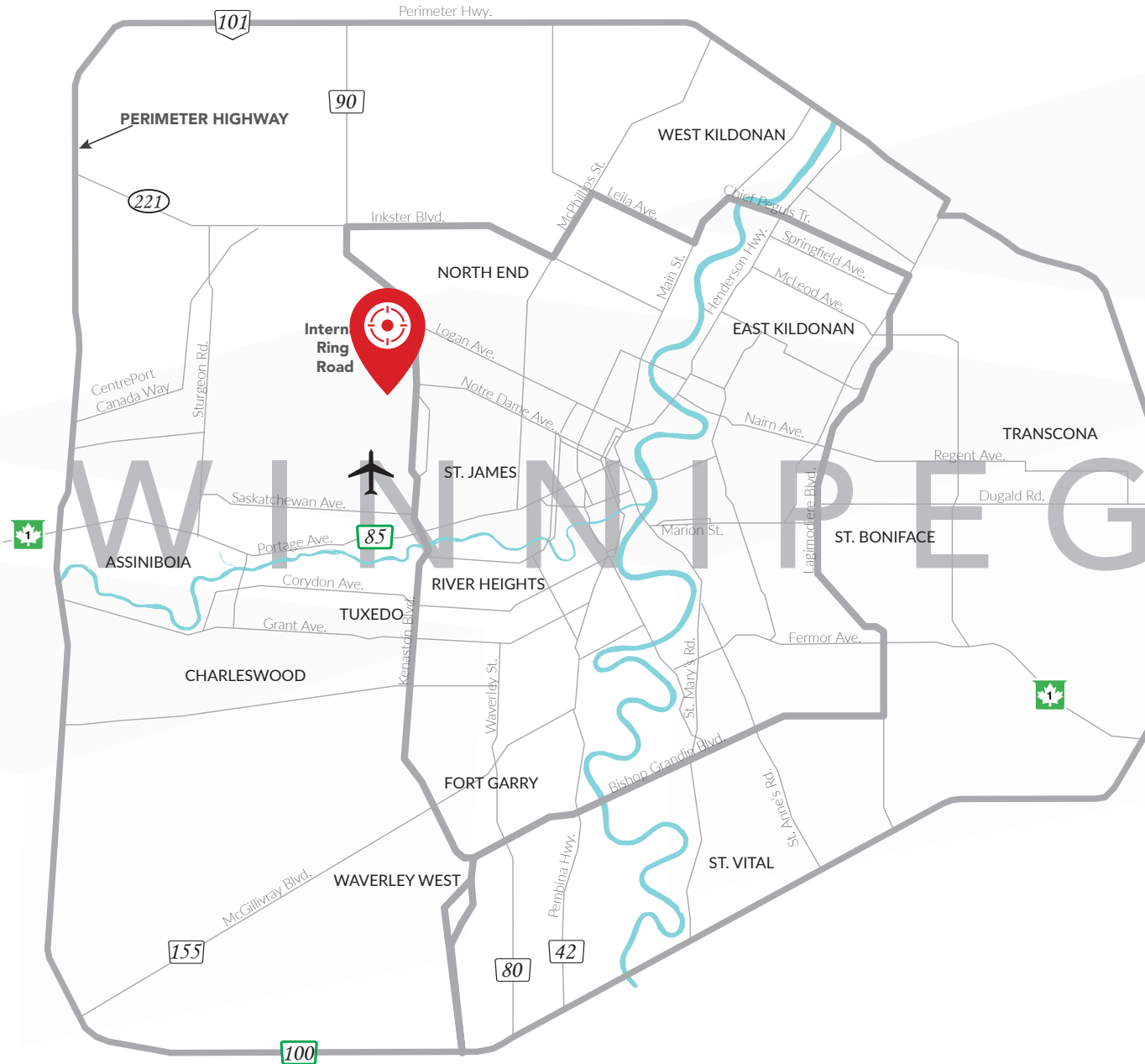

WINNIPEG AIRPORT  
*1 minute*



TRANSCANADA HIGHWAY  
*12 minutes*



CENTREPORT CANADA WAY  
*7 minutes*



PORTAGE & MAIN  
*17 minutes*



CF POLO PARK  
*10 minutes*



COMMERCIAL REAL ESTATE  
SERVICES INC.

## Contact

Gary Goodman, Vice President, Sales & Leasing

(204) 997-4831

[gary.goodman@capitalgrp.ca](mailto:gary.goodman@capitalgrp.ca)

Eric Ott, Associate Vice President, Sales & Leasing

(204) 985-1378

[eric.ott@capitalgrp.ca](mailto:eric.ott@capitalgrp.ca)

*Services provided by Eric A. Ott Personal Real Estate Corporation*

**CAPITAL COMMERCIAL REAL ESTATE SERVICES INC.**

300-570 Portage Avenue, Winnipeg, MB R3C 0G4 | T (204) 943-5700 | F (204) 956-2783 | [capitalgrp.ca](http://capitalgrp.ca)

Disclaimer: Capital Commercial Real Estate Services Inc. ("Capital") does not accept or assume any responsibility or liability, direct or consequential, for the information set out herein, including, without limitation, any projections, images, opinions, assumptions and estimates obtained from third parties. This information has not been verified by Capital, and Capital does not guarantee the accuracy, correctness and completeness of this information. The recipient of this information should take such steps as the recipient may deem necessary to verify the information in this document prior to placing any reliance upon it. The information may change and any property described in this document may be withdrawn from the market at any time without notice or obligation to the recipient from Capital.