

FOR SALE

Capital
COMMERCIAL REAL ESTATE
SERVICES INC.

SE Wedgewood Place

GIMLI, MB

~ Residential Development Land in Gimli, MB ~



BOB ANTYMNIUK, Vice President, Sales & Leasing
(204) 985-1364
bob.antymniuk@capitalgrp.ca

capitalgrp.ca

Property Details



LAND AREA (+/-)	1.66 acres
SALE PRICE	\$430,000.00
TAXES	\$160.39 (2021)
TAX ROLL #	380360
LEGAL DESCRIPTION	LOT 2 BLOCK 3 PLAN 35117 WLTO IN NE 1/4 17-19-4 EPM
ZONING	R1
SERVICES	Site will be fully serviced with municipal sewer and water, hydroelectric power, natural gas, telephone and cable television utilities

LOT MAP

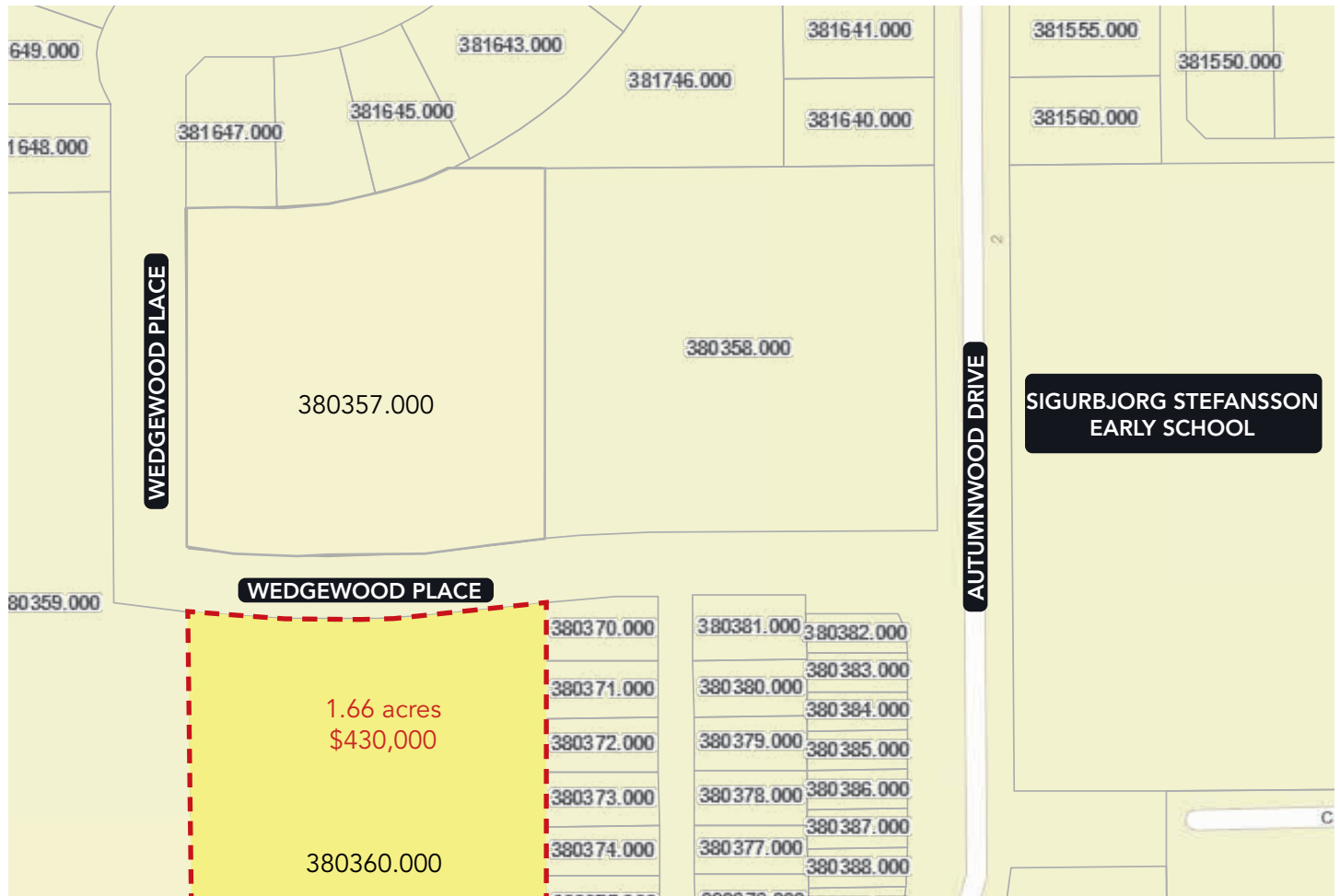

Area Overview

The town of Gimli is located approximately 75 kilometers north of Winnipeg along the west shore of Lake Winnipeg. Gimli's population at the time of the 2016 census was 6,181, a 5.7% increase over the 2011 census. The RM of Gimli resides as a 318.75 square kilometer strip of land stretching north from Winnipeg Beach up to Silver Harbour. The western population of the RM is largely comprised of agricultural lots, while the eastern portion with direct lake access is comprised of single-family residential dwellings and occasional commercial nodes. The west shore of lake Winnipeg features a considerable amount of recreational use of the land both winter and summer. There is a number of small cottage communities within the eastern portion, although the Town of Gimli residing near the physical centre of the RM, is also the largest and most densely populated area within the RM. is a considerable amount of recreational use of the land both winter and summer.

In recent years' residential development has been slow, but continual, as new development sites are ample within Gimli's sprawling agricultural lands; some of these sites include Pelican Beach and Odin Green. Commercial development has existed primarily within the 1,396-acre Gimli Industrial Business Park, which resides on the former Royal Canadian Air Force Base, 6 kilometers west of the Town of Gimli.



Property Photos



Demographic Analysis

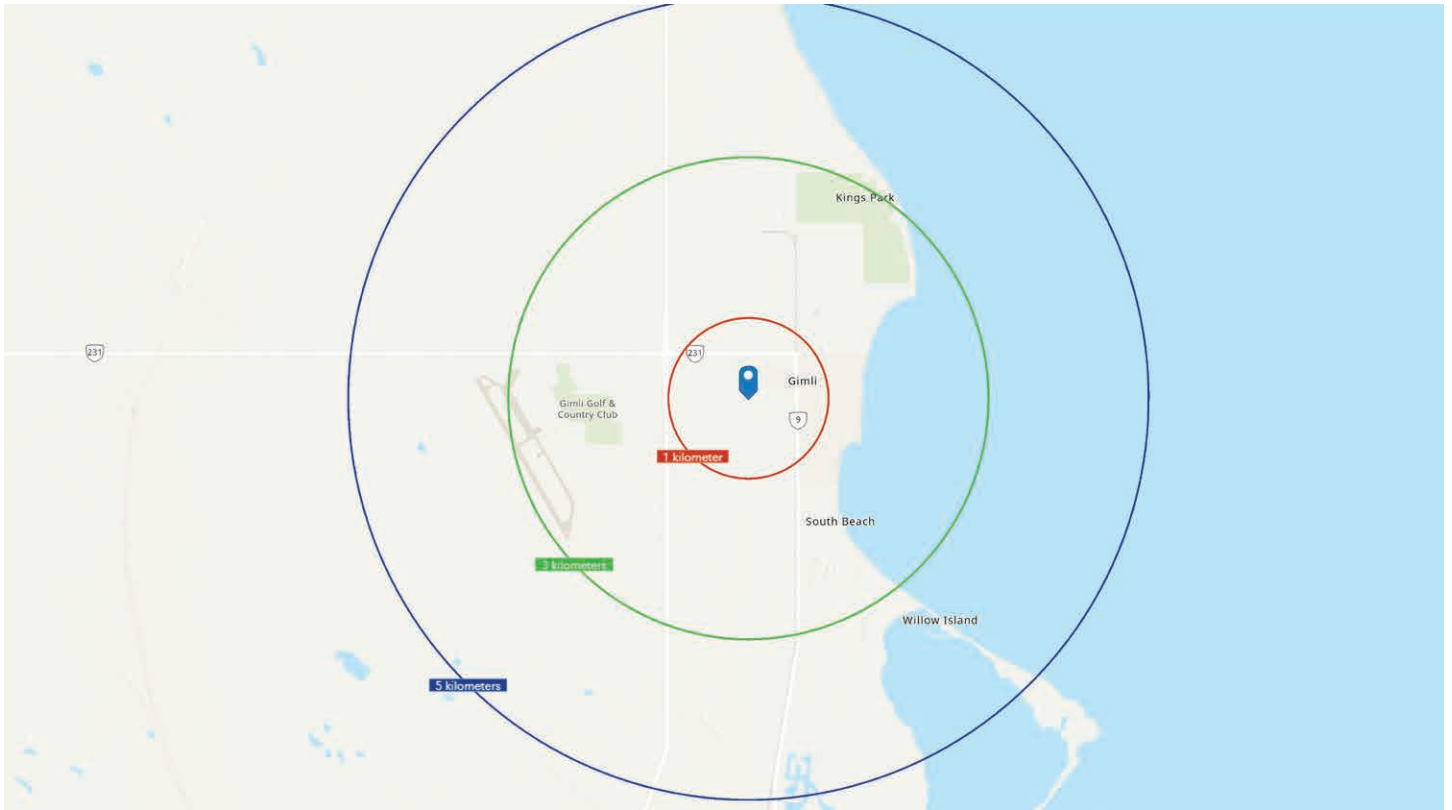

POPULATION



	2022	2027
1 KM	764	767
3 KM	3,138	3,195
5 KM	3,503	3,580

HOUSEHOLD INCOME



	2022	2027
1 KM	\$75,977	\$90,055
3 KM	\$77,471	\$91,784
5 KM	\$77,392	\$91,636

MEDIAN AGE



	Median Age
1 KM	51.4
3 KM	56.7
5 KM	56.2

HOUSEHOLDS



	2022	2027
1 KM	343	1,346
3 KM	346	1,370
5 KM	1,511	1,521

Contact

BOB ANTYMNIUK, Vice President, Sales & Leasing
(204) 985-1364
bob.antymniuk@capitalgrp.ca

CAPITAL COMMERCIAL REAL ESTATE SERVICES INC.

300-570 Portage Avenue, Winnipeg, MB R3C 0G4 | T (204) 943-5700 | F (204) 956-2783 | capitalgrp.ca

Disclaimer: Capital Commercial Real Estate Services Inc. ("Capital") does not accept or assume any responsibility or liability, direct or consequential, for the information set out herein, including, without limitation, any projections, images, opinions, assumptions and estimates obtained from third parties. This information has not been verified by Capital, and Capital does not guarantee the accuracy, correctness and completeness of this information. The recipient of this information should take such steps as the recipient may deem necessary to verify the information in this document prior to placing any reliance upon it. The information may change and any property described in this document may be withdrawn from the market at any time without notice or obligation to the recipient from Capital.