

**FOR LEASE**

# 1081 Ellice Avenue

WINNIPEG, MB

*~ Join Dollar Tree & Cambrian Credit Union ~*



## Property Details

<b>LAND AREA (+/-)</b>	83,706 sq. ft. or 1.9 acres
<b>AREA AVAILABLE (+/-)</b>	4,314 sq. ft.
<b>NET RENTAL RATE</b>	\$14.50 per sq. ft.
<b>ADDITIONAL RENT</b>	\$6.53 per sq. ft. (est. 2023) plus mgmt. fee equal to 5% of Net Rent

### HIGHLIGHTS

- » Located close to the St. James retail node and Polo Park Shopping Centre
- » Excellent access to site through a light-controlled intersection with two points of access from Wall Street and Ellice Avenue
- » Ample parking available on-site
- » Join Dollar Tree

DERRICK CHARTIER, Principal  
(204) 985-1369

[derrick.chartier@capitalgrp.ca](mailto:derrick.chartier@capitalgrp.ca)

Services provided by Derrick Chartier Personal Real Estate Corporation

[capitalgrp.ca](http://capitalgrp.ca)

# Photos



# Site Aerial



# Site Plan

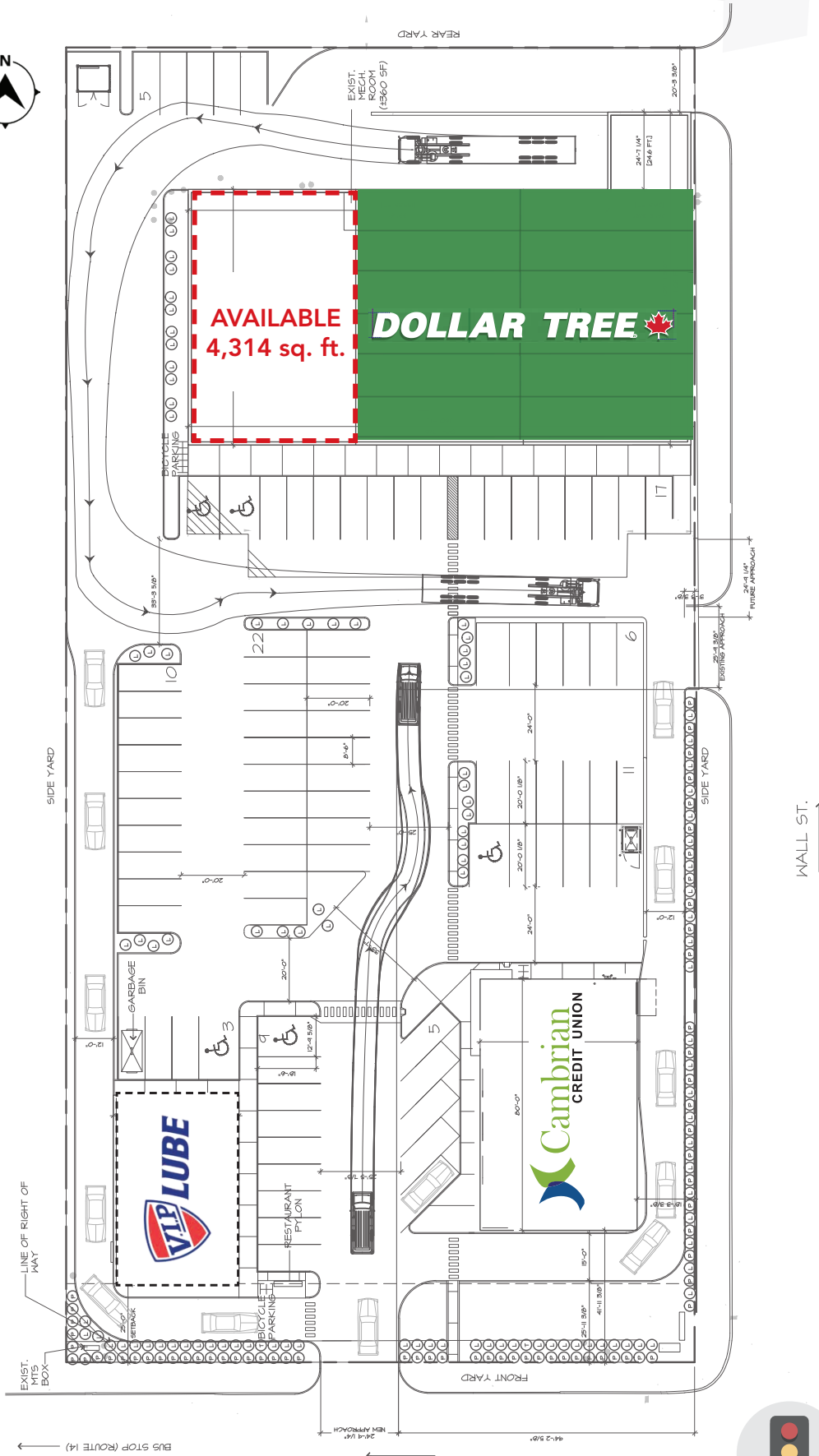

WALL ST. →



ELLICE AVENUE

# Demographic Analysis

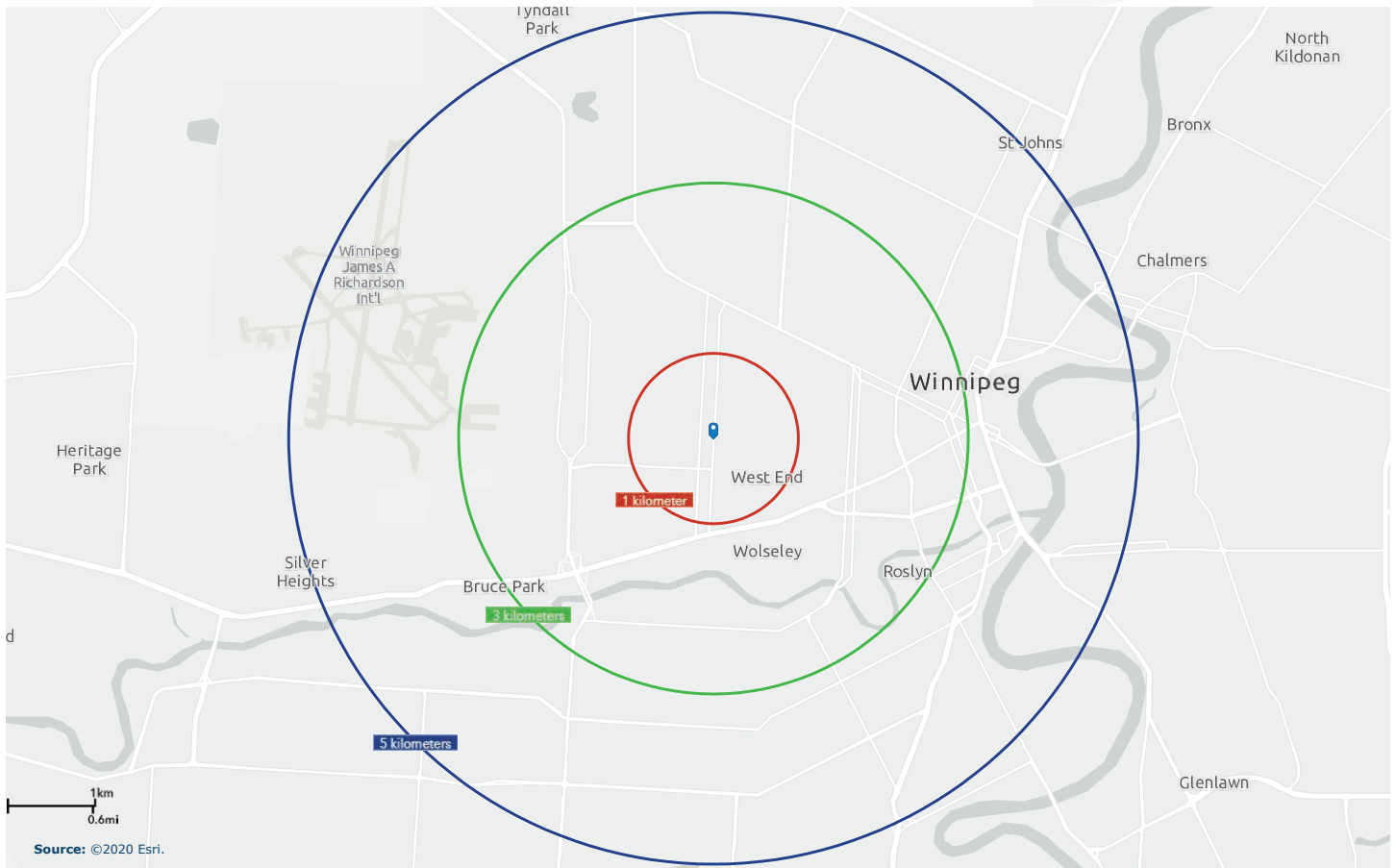

## POPULATION



	Current	2029
1 KM	11,261	12,485
3 KM	67,191	72,593
5 KM	159,261	147,933

## HOUSEHOLD INCOME



	Current	2029
1 KM	\$70,217	\$90,635
3 KM	\$89,432	\$114,378
5 KM	\$86,942	\$112,015

## MEDIAN AGE



	Median Age
1 KM	46
3 KM	42
5 KM	39

## HOUSEHOLDS



	Current
1 KM	5,878
3 KM	28,202
5 KM	62,696

## Contact

DERRICK CHARTIER, Principal  
(204) 985-1369

[derrick.chartier@capitalgrp.ca](mailto:derrick.chartier@capitalgrp.ca)

Services provided by Derrick Chartier Personal Real Estate Corporation

## CAPITAL COMMERCIAL REAL ESTATE SERVICES INC.

300-570 Portage Avenue, Winnipeg, MB R3C 0G4 | T (204) 943-5700 | F (204) 956-2783 | [capitalgrp.ca](http://capitalgrp.ca)

Disclaimer: Capital Commercial Real Estate Services Inc. ("Capital") does not accept or assume any responsibility or liability, direct or consequential, for the information set out herein, including, without limitation, any projections, images, opinions, assumptions and estimates obtained from third parties. This information has not been verified by Capital, and Capital does not guarantee the accuracy, correctness and completeness of this information. The recipient of this information should take such steps as the recipient may deem necessary to verify the information in this document prior to placing any reliance upon it. The information may change and any property described in this document may be withdrawn from the market at any time without notice or obligation to the recipient from Capital.