

~ *New Retail Development Along Provincial Trunk Highway 6* ~



FOR LEASE

8 Highway 6 North

ASHERN, MB

Luke Paulsen, Vice President, Sales & Leasing
(204) 985-1358

luke.paulsen@capitalgrp.ca

Services provided by Luke Paulsen Personal Real Estate Corporation

Presley Bordian, Senior Advisor, Sales & Leasing
(204) 985-1356

presley.bordian@capitalgrp.ca

Capital
COMMERCIAL REAL ESTATE
SERVICES INC.

capitalgrp.ca

Property Overview

THE LOCATION

8 Highway 6 North is located within Ashern, Manitoba, a community recognized as a local urban district located in the Municipality of West Interlake in Manitoba's Interlake Region. Its location offers exposure along Provincial Trunk Highway, a provincial primary Highway connecting the Perimeter Highway of Winnipeg to the Thompson south city limits. It is also the main Highway connecting Winnipeg to northern Manitoba.

PROPERTY DETAILS

LAND AREA (+/-)	34,416 sq. ft.
BUILDING AREA (+/-)	7,001 sq. ft. including Phase 2 Pad Site
AREA AVAILABLE (+/-)	1,335 sq. ft. and up
NET RENTAL RATE	\$20.00 per sq. ft.
ADDITIONAL RENT (est. 2023)	\$5.00 per sq. ft.
PARKING	29 on-site stalls
AVAILABILITY	Immediately
UTILITIES	Separately metered
ELECTRICAL	225 amp/208/120 3-Phase
MECHANICAL	7.5 ton electric RTU/unit



Floor Plan

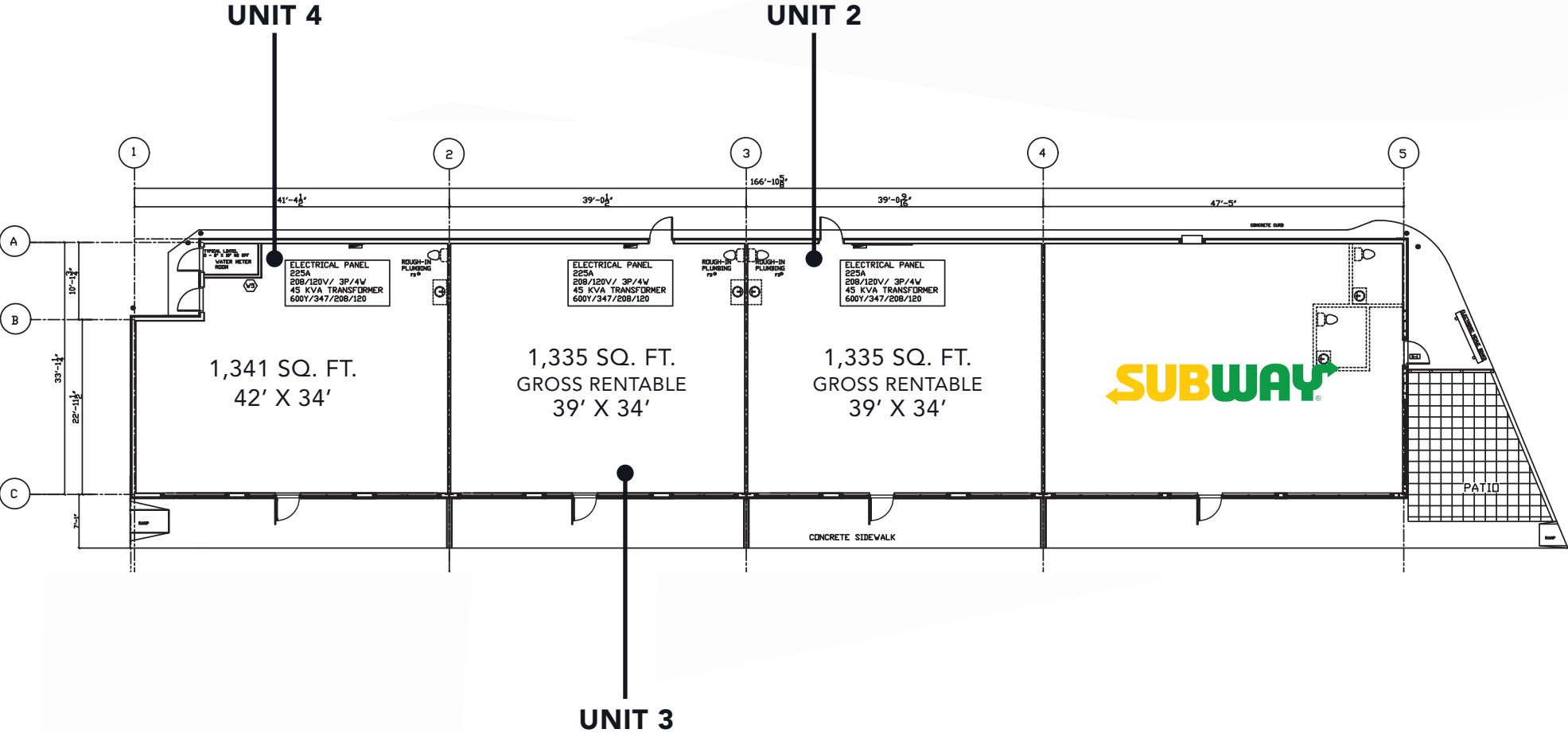

Site Plan

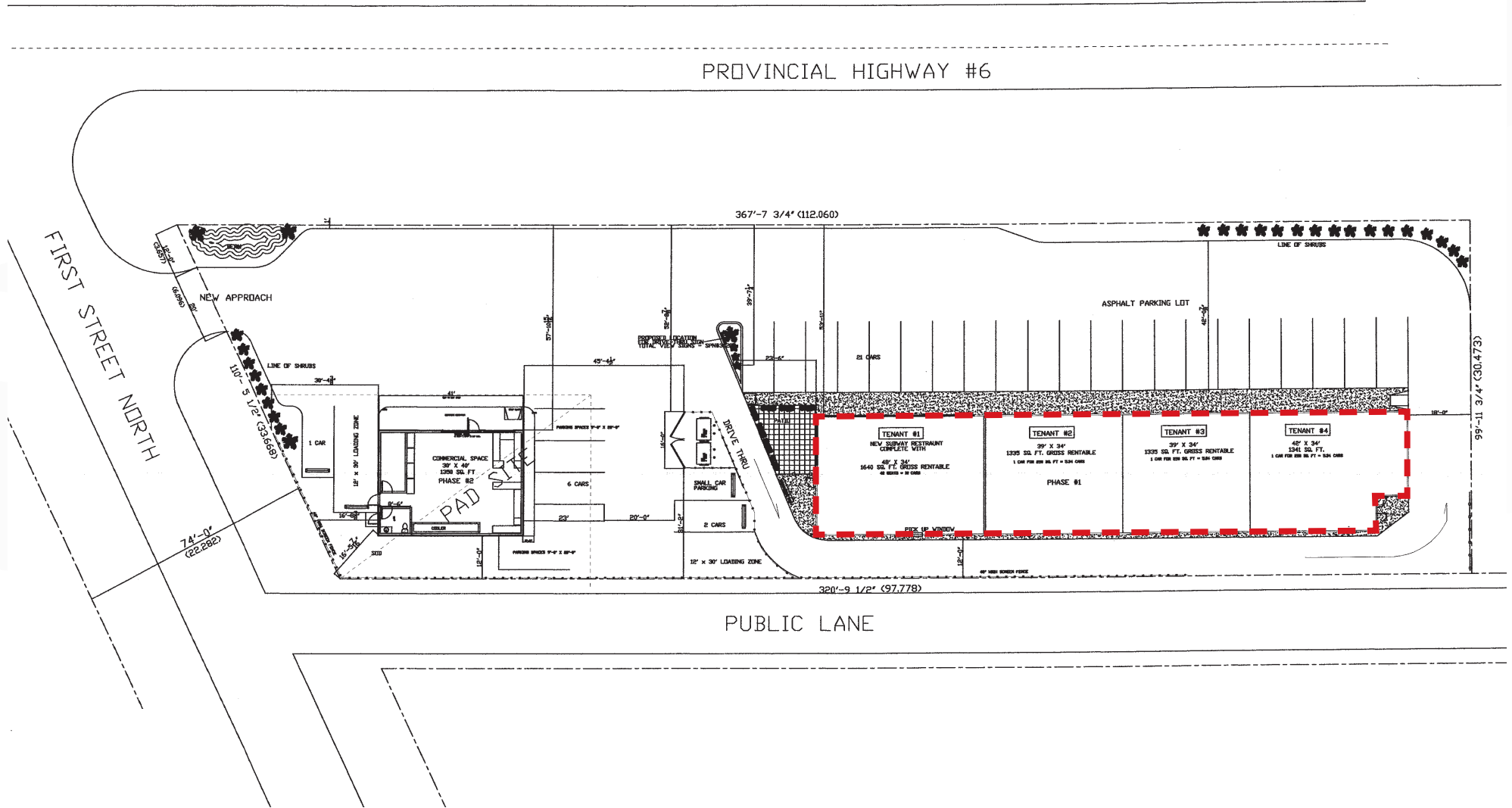



COMMERCIAL REAL ESTATE
SERVICES INC.

Contact

Luke Paulsen, Vice President, Sales & Leasing

(204) 985-1358

luke.paulsen@capitalgrp.ca

Services provided by Luke Paulsen Personal Real Estate Corporation

Presley Bordian, Senior Advisor, Sales & Leasing

(204) 985-1356

presley.bordian@capitalgrp.ca

CAPITAL COMMERCIAL REAL ESTATE SERVICES INC.

300-570 Portage Avenue, Winnipeg, MB R3C 0G4 | T (204) 943-5700 | F (204) 956-2783 | capitalgrp.ca

Disclaimer: Capital Commercial Real Estate Services Inc. ("Capital") does not accept or assume any responsibility or liability, direct or consequential, for the information set out herein, including, without limitation, any projections, images, opinions, assumptions and estimates obtained from third parties. This information has not been verified by Capital, and Capital does not guarantee the accuracy, correctness and completeness of this information. The recipient of this information should take such steps as the recipient may deem necessary to verify the information in this document prior to placing any reliance upon it. The information may change and any property described in this document may be withdrawn from the market at any time without notice or obligation to the recipient from Capital.