

~ Retail/Office Opportunity within Grocery Anchored Strip Mall ~



**FOR LEASE**



# Windsor Park Shopping Centre

**664 ELIZABETH ROAD, WINNIPEG, MB**

BRETT CHARTIER,  
Associate Vice President, Sales & Leasing  
(204) 985-1366  
[brett.charteir@capitalgrp.ca](mailto:brett.charteir@capitalgrp.ca)

Services provided by Brett Chartier Personal Real Estate Corporation

DAWSON GROENING,  
Advisor, Sales & Leasing  
(204) 985-1383  
[dawson.groening@capitalgrp.ca](mailto:dawson.groening@capitalgrp.ca)

[capitalgrp.ca](http://capitalgrp.ca)

# Property Details

**BUILDING AREA (+/-)** 33,155 sq. ft.

<b>AREA AVAILABLE (+/-)</b>	Tenant A:	2,027 sq. ft.
	Tenant B:	1,125 sq. ft.
	Total:	3,152 sq. ft.

**NET RENTAL RATE** \$17.00 per sq. ft.

**ADDITIONAL RENT** \$7.34 per sq. ft. (est. 2023) plus 5% mgmt fee of Net

**ZONING** C2

**TRAFFIC COUNT** 24,100 (average daily traffic count on Elizabeth Road) (2018 City of Winnipeg Traffic Flow Map)

**AVAILABILITY** Immediately



# Floor Plan

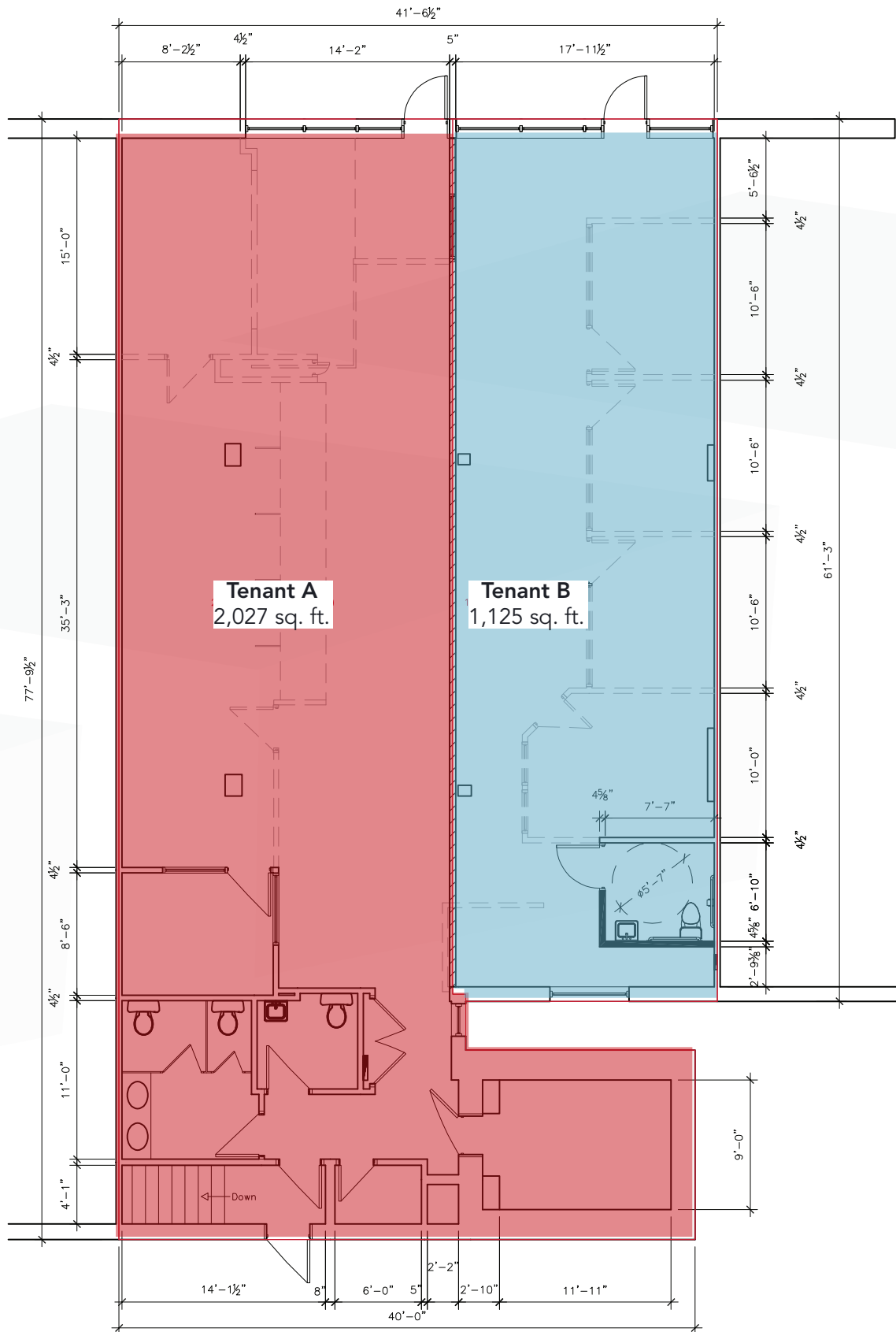

# Interior Photos



# Demographic Analysis



POPULATION	Total Population (2024)	Projected Population (2027)
1 KM	5,665	5,609
3 KM	51,510	52,132
5 KM	168,708	182,779



MEDIAN AGE	Median Age (2024)
1 KM	38.0
3 KM	39.9
5 KM	38.4



HOUSEHOLD INCOME	Avg. Household Income (2024)	Projected Household Income (2027)
1 KM	\$90,071	\$103,427
3 KM	\$89,974	\$103,467
5 KM	\$90,694	\$104,687



HOUSEHOLDS	Total Households (2024)
1 KM	2,235
3 KM	22,294
5 KM	73,935



**Scotiabank**

## Contact

**BRETT CHARTIER**, Associate Vice President, Sales & Leasing  
(204) 985-1366

[brett.charteir@capitalgrp.ca](mailto:brett.charteir@capitalgrp.ca)

*Services provided by Brett Chartier Personal Real Estate Corporation*

**DAWSON Groaning**, Advisor, Sales & Leasing  
(204) 985-1383

[dawson.groaning@capitalgrp.ca](mailto:dawson.groaning@capitalgrp.ca)

## **CAPITAL COMMERCIAL REAL ESTATE SERVICES INC.**

300-570 Portage Avenue, Winnipeg, MB R3C 0G4 | T (204) 943-5700 | F (204) 956-2783 | [capitalgrp.ca](http://capitalgrp.ca)